



Whitemoor Lakes Residential Visit

Monday 2nd June – Friday 6th June 2025

Year 5 and 6 residential visit

- Risk taking and pushing beyond barriers
- Real adventures
- Independent living



Where are we going?

- ▶ Whitemoor Lakes is a residential outdoor education centre situated in Staffordshire.
- ▶ Friendly, welcoming and experienced staff
- ▶ A wonderful location
- ▶ Experiential learning and personal and social development





Why are we going?

- ▶ Their ethos is:
 - ▶ Respect
 - ▶ Teamwork
 - ▶ Challenge
 - ▶ Responsibility
 - ▶ These are things we all want from our children
- 



The centre

- ▶ Dining Room – very good selection of food and great catering for children with additional dietary needs.
- ▶ Bedrooms – Sleep between two and 10 people. Staff spread between the children.
- ▶ Cloakroom, and drying room.
- ▶ Our own dedicated lodge with our own common room.
- ▶ Equipment – specialist equipment that is fully safety checked

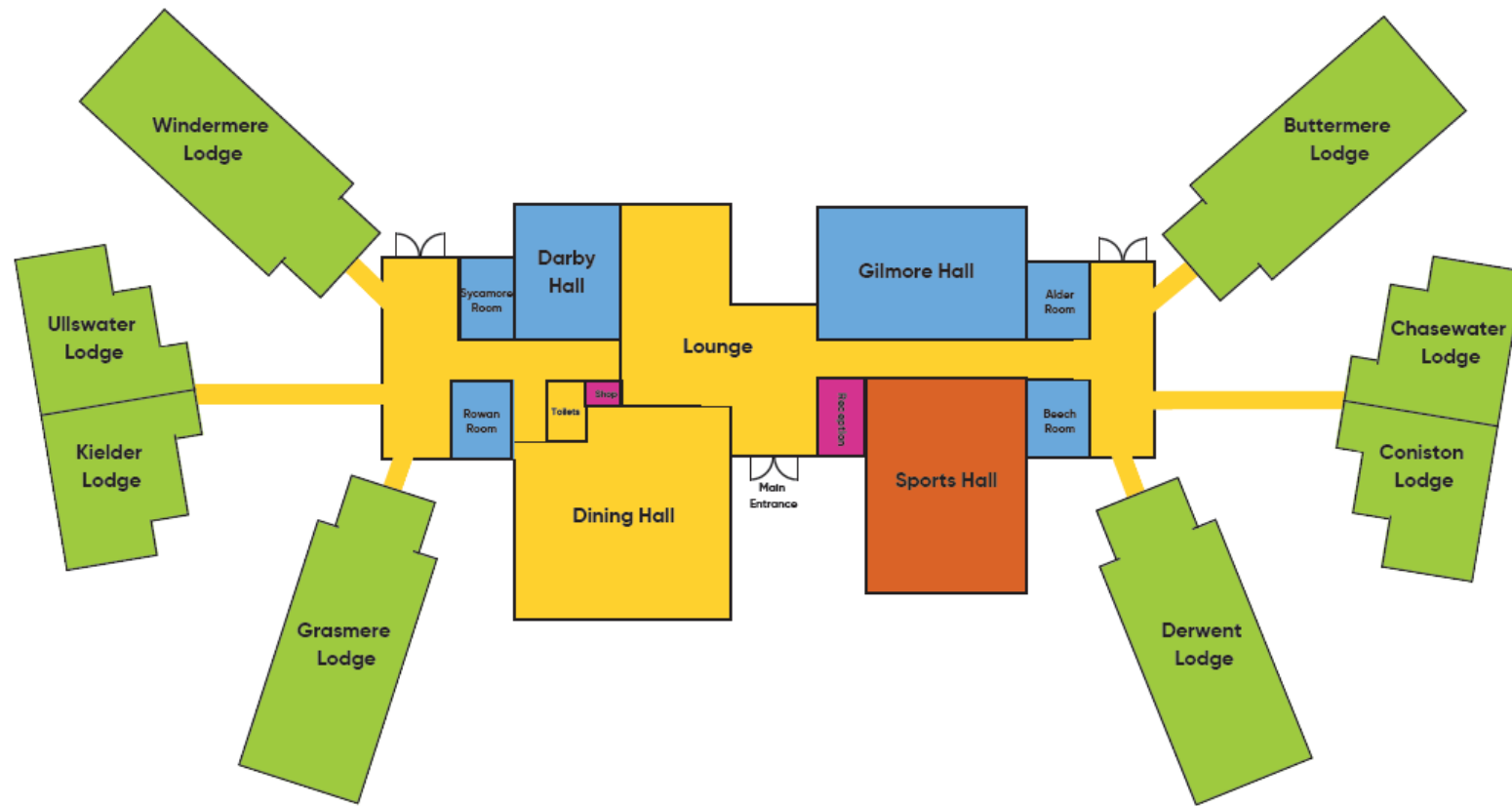

Venue Rooms
 Residential Lodges
 Communal Areas

Ullswater Lodge

Whitemoor Lakes

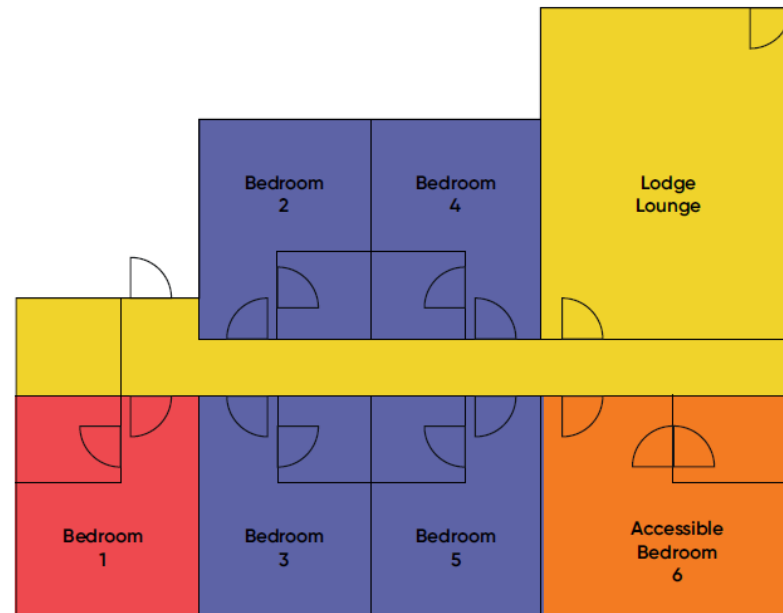

All bedrooms are ensuite with bath tubs except our accessible rooms which have wet rooms.

 3 Beds
(3 Single Beds)

 6 Beds
(3 Bunk Beds)

 7 Beds
(1 Single Bed & 3 Bunk Beds)

Sample Timetable

		Monday				Tuesday				Wednesday				Thursday				Friday				
		11.00	2.00-3.30	4.00-5.30	7.00-8.00	9.30-11.00	11.00-12.30	2.00-3.30	4.00-5.30	7.00-8.00	9.30-11.00	11.30-1.00	2.00-3.30	4.00-5.30	7.00-8.00	9.30-11.00	11.30-1.00	2.00				
Group 1	Arrive & Welcome	Zipwire 1	Archer y 1	Extreme Teams	Canoeing 1	Challenge Course 1	Climbing 1	Raft Building 1	Campfire 1	Leap of Faith 2	Orienteering 1	Giant SUP 1	Buggy Building 1	Disco	Abseiling 1	Traverse 1	Problem Solving 1	Gladiator 1	Night Walk 1	Sailing 1	Team Games	Depart & Goodbyes
Group 2		Leap of Faith 2	Zipwire 1		Archery 1	Canoeing 1	Challenge Course 1	Climbing 1		Raft Building 1	Orienteering 2	Sailing 1	Giant SUP 1		Buggy Building 1	Abseiling 1	Traverse 1	Problem Solving 1		Gladiator 1		



Organisation

- ▶ 2 (possibly 3) school adults
- ▶ Dates – Monday 2nd June 2025 – Friday 6th June 2025
- ▶ Coach
- ▶ Cost £430 per pupil – spread the cost throughout 18 months
- ▶ PE Premium Subsidy of £1000
- ▶ PET grant application – for families requiring additional support



Declaration of interest

- ▶ Please complete the interest form and return to school by 15th October
- ▶ We will set up the payment item on Parent Pay. Please keep up to date with payments as we have to pay Whitemoor Lakes periodically.
- ▶ You can part pay this throughout the year, although we will need a deposit of £30 by 27th October 2023.
- ▶ Balance to be paid by 21st April 2025.
- ▶ Financial assistance – please do come and speak to us.